

DESCRIPTION

The N-8540DS is an IP door station employing packet audio technology. Connecting the N-8540DS to an IP network (LAN or WAN) permits hands-free conversation of high sound quality to be made between the N-8540DS and the intercom station connected to the IP Intercom Exchange, or between the N-8540DS and an IP multifunctional master station. Besides, the N-8540DS can be used in conjunction with the Multi Interface units through a network. It is in full conformity with IP54 water-proof and dust-proof standards. The operating temperature range is -10 to 50 °C. As provided with guard nets inside to cover over the openings of microphone and speaker, the N-8540DS can be installed free from care in public space.

SPECIFICATIONS

Power Source	Power supply device that complies with IEEE802.3af standard or 12 V DC (supplied from the AC adapter (option))
Power Consumption	4.2 W (at rated), 6 W (max.)
Speech Method	Hands-free conversation
Audio Frequency Range	300 Hz - 7 kHz
Hands-free	Speaker: 3.5 cm cone-type, 1 W, 8 Ω Microphone: Omni-directional electret condenser microphone
Contact Output	Open collector output, withstand voltage: 30 V DC, control current: 50 mA one shot: can be set from 1 to 9 sec, screw terminal (polarized)
Network Section	Network I/F: 10BASE-T/100BASE-TX (Automatic-Negotiation) Network protocol: TCP/IP, UDP, HTTP, RTP, ARP, ICMP, IGMP Audio packet transmission system: Unicast, Multicast Number of paging destinations: 0, *Reception only Connector: LAN: RJ45 connector (PoE compatible) Voice sampling frequency: 16 kHz, 8 kHz (controllable on the software) Quantifying bit number: 16-bit Voice encoding method: Sub-band ADPCM, Cryptosystem Voice packet loss recovery: Silence insertion Audio delay time: 80 ms, 320 ms (controllable on the software)
Indication	Status lamp
Installation Method	Flush-mount/Surface-mount
Operating Temperature	-10 °C to +50 °C
Operating Humidity	Under 90 % RH (no condensation)
Housing Protection	BS EN62262: 2002: IK02 equivalent
Dust/Water Protection	IP54 (Note that panel edges must be sealed at installation.)
Finish	Plate: Stainless steel (SUS304), hairline Call button: Metal
Dimensions	115 (W) × 162 (H) × 55.1 (D) mm
Weight	700 g
Accessory	Box mounting screw (No.6-32UNC × 18) ×4, Box mounting screw (M4 × 25) ×4, Ferrite clamp ×1,
Option	AC adapter: AD-1210P
Applicable Box (option)	For wall mount: Wall-mount Box YS-13A For flush mount: 3-gang electrical box or Back Box YC-150

APPEARANCE

Top View

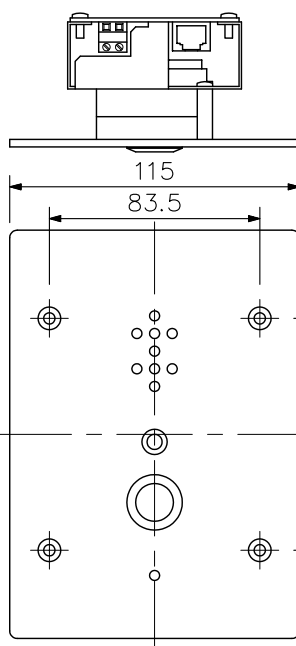

* An AC adapter, when used as power source, cannot be put in the YS-13A, YC-150, or a 3-gang electrical box together with the N-8540DS because such boxes do not have enough room to accommodate both.

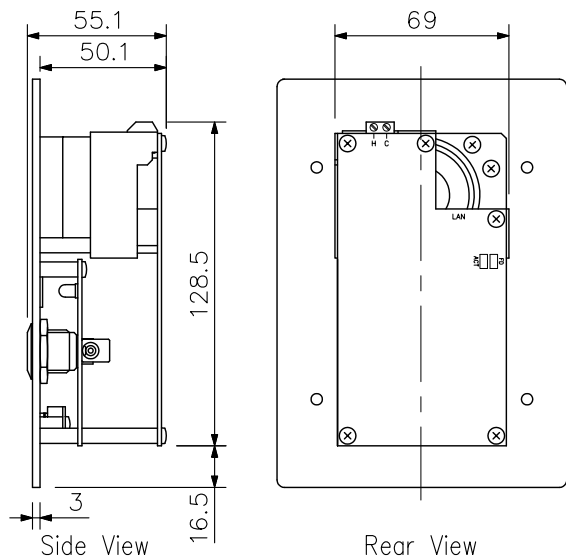

UNIT:mm SCALE:1/3 Front View

Side View

Rear View